

EI-6800-NI1

Embedded NVR

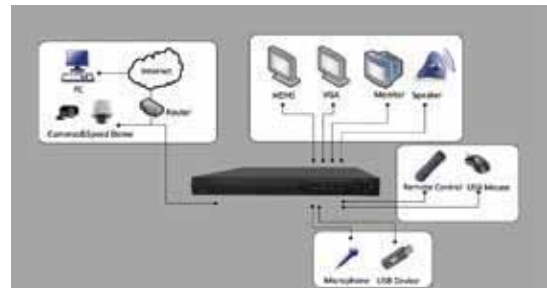

Key features

- Third-party network cameras supported
- Up to 5 Megapixels resolution recording
- HDMI and VGA output at up to 1920x1080P resolution
- 8-ch synchronous playback
- HDD quota and group management

Rear Panel



1. Video out
2. Audio out
3. Audio in
4. RS-232
5. VGA interface
6. HDMI interface
7. USB interface
8. LAN
9. RS-485 interface, alarm in, alarm out
10. 12 VDC power supply
11. Switch

EI-6800-NI1

Video / Audio input

IP video input	8-ch
Audio in	1-ch, BNC (2.0 Vp-p, 1kΩ) (Voice talk input)

Video / Audio output

Recording resolution	5MP /3MP /1080P /UXGA /720P /VGA /4CIF /DCIF /2CIF /CIF /QCIF
CVBS output	1-ch, BNC (1.0 Vp-p, 75 Ω) Resolution: 704 × 576 (PAL); 704 × 480 (NTSC)
HDMI output	1-ch, resolution: 1920 × 1080P /60Hz, 1920 × 1080P /50Hz, 1600 × 1200 /60Hz, 1280 × 1024 /60Hz, 1280 × 720 /60Hz, 1024 × 768 /60Hz
VGA output	1-ch, resolution: 1920 × 1080P /60Hz, 1600 × 1200 /60Hz, 1280 × 1024 /60Hz, 1280 × 720 /60Hz, 1024 × 768 /60Hz
Audio output	1-ch, BNC (Linear, 600Ω)
Playback resolution	5MP /3MP /1080P /UXGA /720P /VGA /4CIF /DCIF /2CIF /CIF /QCIF
Synchronous playback	8-ch

Hard disk

SATA	2 SATA interfaces
Capacity	Up to 4TB capacity for each disk

External interface

Network interface	1 RJ-45 10 /100 /1000 Mbps self-adaptive Ethernet interface
Serial interface	1 RS-232 interface (for parameters configuration, maintenance , transparent channel);1 RS-485 interface (reserved);
USB interface	2, USB 2.0
Alarm in	4
Alarm out	2

General

Power supply	12 VDC
Consumption	≤ 13 W (without hard disk or DVD-R/W)
Working temperature	-10 °C ~ +55 °C
Working humidity	10%~90%
Chassis	19-inch rack-mounted 1U chassis
Dimensions (W x D x H)	445 × 261 × 44.5 mm
Weight	≤ 4 Kg (without hard disk or DVD-R/W)