

Monoblok Ölçü Sayfaları

Monoblock Dimension Pages

Monoblok Maßblätter

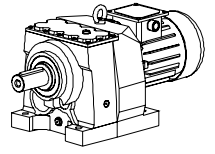

-Mil ucu çektirme deliği DIN 332,sayfa 2

-Tapped center hole to DIN 332, sheet 2

-Zentrierung mit gewinde DIN 332, Blatt 2

MR202...
MR203...

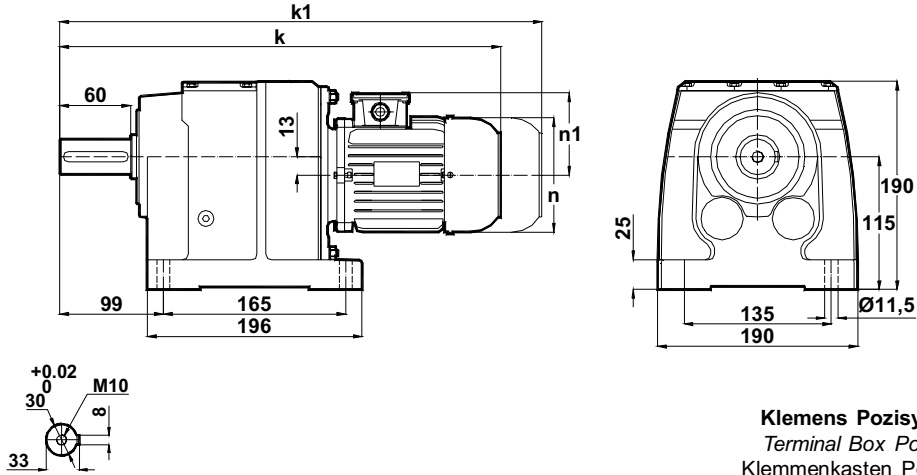

Klemens Pozisyonları
Terminal Box Positions
Klemmenkasten Positionen

	63	71	80	90S	90L	100L	112M
k	436	455	484	512	537	576	598
k1	-	575	604	637	662	711	733
n	121	138	156	176	176	194	218
n1	98	110	118	126	126	135	146

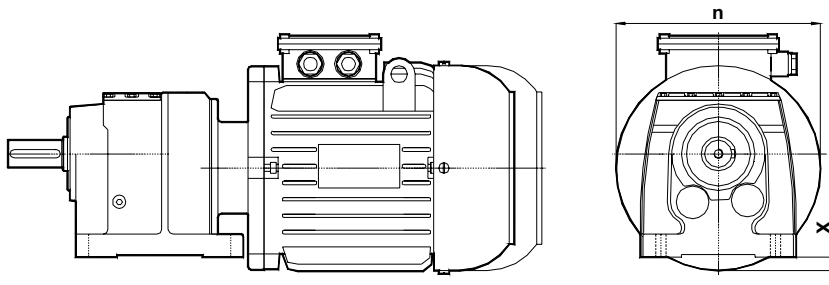
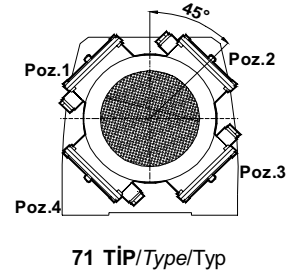
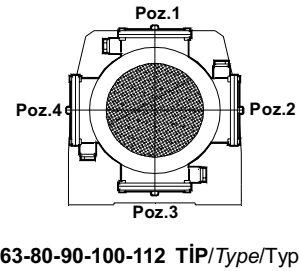

	63	71	80	90	100	112
n	121	138	156	176	194	218
X	-	-	-	-	-	10

" k1" Ölçüsü frenli redüktörlere aittir. 71 tip elektrik motorlu redüktörler soğutmasız, diğerleri soğutmalıdır.
Dimension "k1" is for motors with brake. Gear boxes with 71 type electrical motors are not fan cooled, other types are fan cooled.
MaBe "k1" ist für Bremsenmotoren. Getrieben mit 71 typ Motoren sind ohne Kühlung, andere Typen sind mit Ventilator gekühlt.