

Product description

**Contacts: 2, male angled connector, shieldable, cable outlet 6 - 8 mm, silver plated contacts, UL approval**

Area

**M16 IP67 Series 423**

Order number

**99 5601 75 02**

**Illustration**



**Scale drawing**

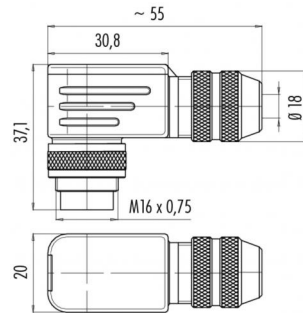

**Contact arrangement**

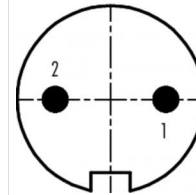

	X	Y
1	3,50	0,00
2	-3,50	0,00

**Derating curve**

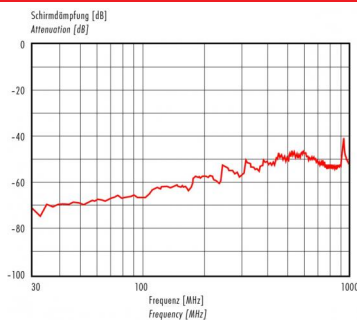

**You can find the component part drawing and assembly instructions on the next page.**

**Technical data**

**General values**

Connector design	male angled connector
Connector locking system	bolted
Termination	solder
Wire gauge (mm)	0,75 mm <sup>2</sup>
Wire gauge (AWG)	20
Cable outlet	6 - 8 mm
Upper limit temperature	95 °C
Lower limit temperature	-30 °C

**Electrical values**

Rated voltage	250 V
Rated impulse voltage	1500 V
Pollution degree	1
Overvoltage category	I
Insulating material group	III
Rated current (40 °C)	7 A
Volume resistivity	≤ 5 mΩ
EMC compliance	shieldable
Degree of protection	IP67
Mechanical operation	> 500 Mating cycles

**Cable data**

Approval 1	UL
------------	----

**Material**

Contact material	CuZn (Messing)
Contact plating	Ag (silver)
Contact body material	PBT (UL 94 V-0)

Product description

**Contacts: 2, male angled connector, shieldable, cable outlet 6 - 8 mm, silver plated contacts, UL approval**

Area

**M16 IP67 Series 423**

Order number

**99 5601 75 02**

Component part drawing

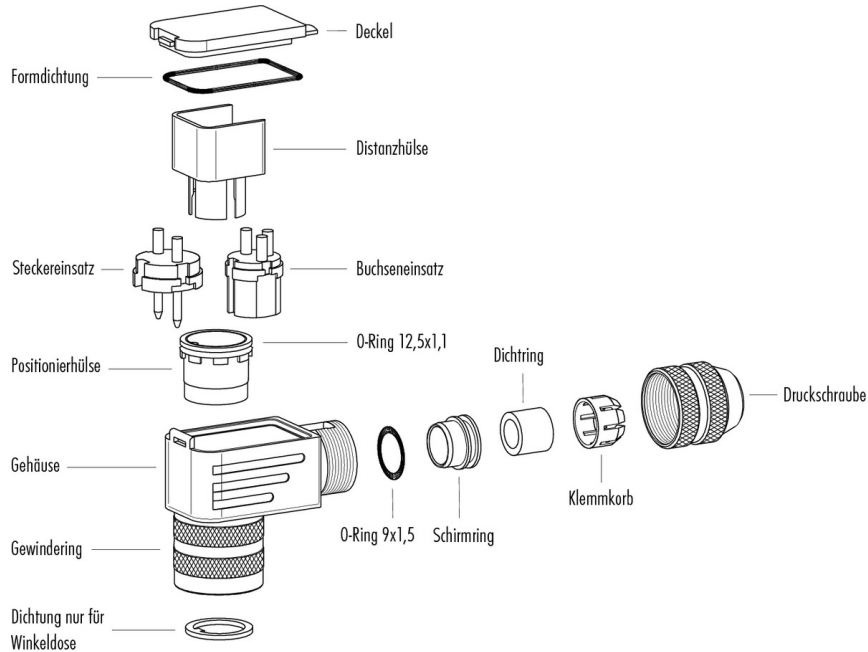

Assembly instructions / Panel cut-out

**Winkelversion**

1. Dichtungen montieren (3x).
2. Kabelteile auffädeln.
3. Kabel und Schirm abmanteln.
4. Litzen durch das Gehäuse fädeln.
5. Schirmring, Klemmkorb montieren.
6. Druckschraube leicht andrehen.
7. Litzen an Kontakteinsatz löten.
8. Verdrehhülse in Winkelstellung montieren.
9. Kontakteinsatz, Distanzhülse einsetzen.
10. Deckel einhaken.
11. Druckschraube festziehen (ca. 10-20 Nm).

**Angled version**

1. Assemble sealing rings (3x).
2. Bead cable parts.
3. Dismantle cable and shielding braid.
4. Push single wires through housing.
5. Mount shielding ring and pinch ring.
6. Slightly fix pressing screw.
7. Solder wires to insert.
8. Mount positioning sleeve in angled position.
9. Put in insert and distance sleeve.
10. Mount lid.
11. Fix pressing screw (approx. 10-20 Nm).

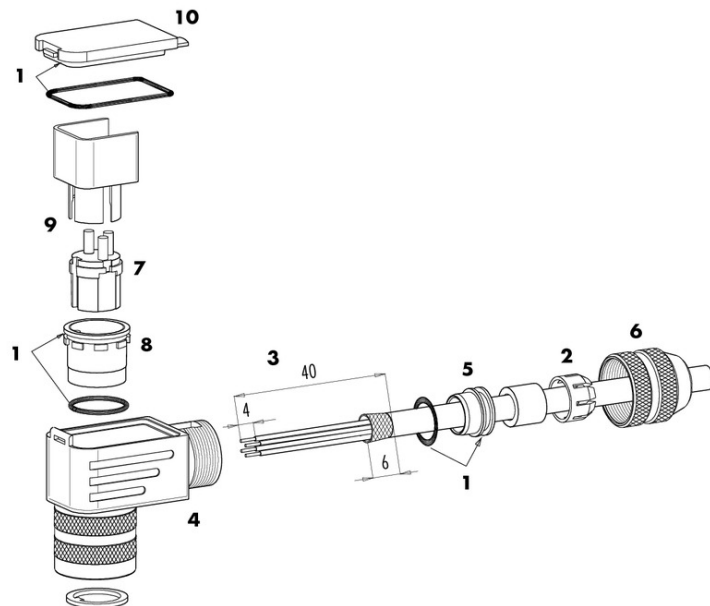

Product description	<b>Contacts: 2, male angled connector, shieldable, cable outlet 6 - 8 mm, silver plated contacts, UL approval</b>
Area	<b>M16 IP67 Series 423</b>
Order number	<b>99 5601 75 02</b>

## Sicherheitshinweise

1. The connector must not be connected or separated under load. Non-observance and incorrect use can result in personal injury.
2. The connectors are designed for use in plant, control system and electrical equipment. The end user is responsible for checking whether the connectors are suitable for use in other applications.
4. Connectors used in electrical circuits containing hazardous life parts must only be assembled and used by or under the supervision of persons with the requisite electrotechnical training, taking the applicable regulations and standards into account.
6. Connectors with degree of protection IP 67 and IP 68 are not suitable for use under water. When used outdoors, the connectors must be separately protected against corrosion. For further information about IP degrees of protection refer to 'Technical support' in the Download Centre.
7. The connector is not suitable for mains voltages. Please observe the pollution degrees and the overvoltage category. For further information refer to 'Technical support' in the Download Centre.
8. To lock the cable connector to the equipment connector, the threaded ring is tightened until it is 'finger-tight' (approx. 50 cNm).