

Datasheet

Art.No. 76.440.2535.1

Bottom HD GUT MR 25 M20 50 A1

revos HD size 16/25 closed-bottom base with 2 threaded collar M20, with cover, single locking lever

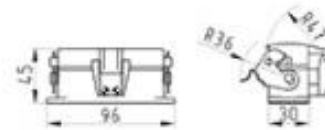

| | |
|------------|---------------|
| Art.No. | 76.440.2535.1 |
| EAN | 4015573822795 |
| Order unit | 1 pieces |

Approvals

Technical data

General

| | |
|--|---------------------|
| Housing material | Aluminium |
| Colour | Grey |
| Surface | With powder coating |
| Degree of protection (IP) | Other |
| UV resistant | Yes |
| Inflammability class of insulation material acc. with UL94 | Other |
| Operating temperature range min. | -40 °C |
| Operating temperature range max. | 120 °C |

Model

| | |
|------------------------|-------------------------|
| DIN-size | 16/25 |
| Model | Surface mounting (base) |
| Locking mechanism | Single locking lever |
| Cable entry | Two-sided |
| Type of cable | Thread |
| With cable screw gland | No |
| Thread size M | 20 |
| Hinged lid | Yes |
| EMC-version | No |

Classification

| | |
|------------|--|
| ECLASS 8.1 | 27440202: Housing for industrial connectors |
| ETIM 6.0 | : EC000437 |
| ETIM 5.0 | EC000437: Housing for industrial connectors |
| ETIM 4.0 | EC000437: Housing for industrial connectors |
| ETIM 3.0 | EC000437: Housing for industry plug connectors |

Drawings

